

1000 C SERIES ROTARY JOINTS



CONTINUOUS CASTING
 WATER
 1/2" (DN08) - 1 1/2" (DN40)

- Mono or duoflow
- In-the-shaft mounted
- Flat type housing
- Brass housing and elbow
- Stainless steel shaft and screws
- Self supported sealing parts
- Silicon Carbide sealing parts

Working Conditions

Max. Water Pressure	:	10,5 Bar
Max. Water Temperature	:	120°
Max. Speed	:	100 rpm/min

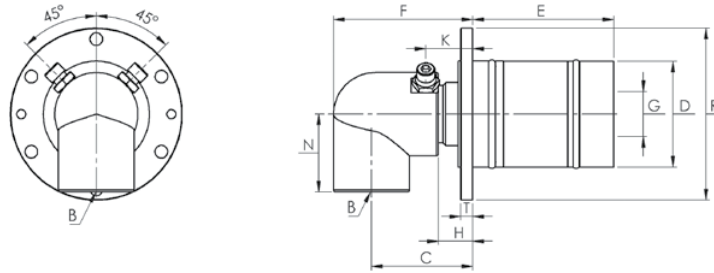
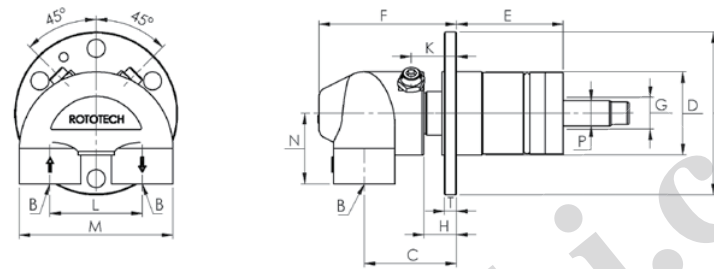

1000 C Series 1/2" (DN15) - 1 1/2" (DN40) Single Flow Rotary Joints

1000 C Series 1/2" (DN15) - 1 1/2" (DN40) Dual Flow Rotary Joints

1000C SERIES ROTARY JOINTS

Size	Type	B	Elbow Thread	Model No	F	E	D	R	T	K	H	G	N	L	M	C	P	Kg
DN15	MONO FLOW	1/2"	BSP	1052-3200-000	67,00	50,00	40,00	62,00	7,00	25,00	19,00	13,50	31,50			51,00		2,10
			NPT	1051-3200-000														
DN20		3/4"	BSP	1072-3300-000	58,50	59,00	46,00	77,00	7,00	25,00	19,00	17,50	48,00			42,00		2,25
			NPT	1071-3300-000														
DN25		1"	BSP	1102-3400-000	77,00	78,00	58,70	95,00	7,00	26,00	19,00	25,00	43,00			56,00		2,80
			NPT	1101-3400-000														
DN40		1 1/2"	BSP	1152-3500-000	96,00	87,00	70,70	110,00	7,00	26,00	19,00	40,00	49,00			67,50		3,45
			NPT	1151-3500-000														
DN15	DUAL FLOW	1/2"	BSP	1054-3300-000	77,00	49,00	40,00	62,00	7,00	25,00	19,00	13,50	35,00	44,00	73,00	47,00	13,00	2,40
NPT			1053-3300-000															
DN20		3/4"	BSP	1074-3400-000	77,00	78,00	58,70	95,00	7,00	26,00	19,00	25,00	39,00	51,00	85,00	52,00	19,00	3,00
			NPT	1073-3400-000														
DN25		1"	BSP	1104-3400-000	98,50	78,00	58,70	95,00	7,00	26,00	19,00	25,00	43,00	63,50	105,50	67,50	19,00	3,75
			NPT	1103-3400-000														
DN40		1 1/2"	BSP	1152-3500-000	99,00	87,00	70,70	110,00	7,00	26,00	19,00	40,00	43,00	63,50	105,50	68,00	21,00	3,85
			NPT	1151-3500-000														

